

THE ELEM³ENT

MAJARA LUXURY REAL ESTATE LLC

Head Office Level 36-01, Po Box :124382 , Trade Center 1, Sheikh Zayed Road , Burj Al Salam Tower Dubai UAE



Majara Presents The Element at One – Elevated Living in Ras Al Khor, Dubai

The Golden Gateway to the Heart of the UAE

In Dubai, luxury is a way of life. Experience unrivaled sophistication, exclusive experiences, and a world of endless opportunities.



The Epitome of a Distinguished Address



One blends luxury, community, and nature seamlessly—lush landscapes, a premier golf course, and world-class facilities create a haven where residents thrive.

Nestled gracefully between the twin interchanges of Ras Al Khor Road lies a sanctuary touched by the essence of the elements. The Ras Al Khor Wildlife Sanctuary stretches its timeless arms across the horizon, while the serene waters of the Creek and the dynamic Dubai skyline create a striking juxtaposition. Here, nature and urban ambition converge, reflecting harmony, balance, and the eternal flow of life’s interconnected beauty



 RAS AL KHOR WILDLIFE SANCTUARY 10 MINUTES	 MEYDAN RACE COURSE 10 MINUTES	 SOBHA HARTLAND & 2 INTERNATIONAL SCHOOLS 10 MINUTES	 DUBAI INTERNATIONAL AIRPORT 10 MINUTES	 BUSINESS BAY 10 MINUTES
 THE DUBAI MALL 10 MINUTES	 BURJ KHALIFA & DOWNTOWN DUBAI 10 MINUTES	 DUBAI FRAME 10 MINUTES	 DUBAI OPERA 10 MINUTES	 PALM JUMEIRAH 10 MINUTES

Experience luxury reimagined, where panoramic views stretch from Dubai Downtown to the Ras Al Khor Wildlife Sanctuary, blending cityscape, waterways, and horizon in perfect harmony.







An Urban Masterpiece in Perfect Harmony with Nature

The Element: An architectural masterpiece where elegance meets expansive spaces, offering breathtaking views and a lifestyle defined by luxury, tranquility, and refinement.



A New Standard in Refined Living.



Experience a lifestyle where panoramic views, natural light, and modern comforts converge. Find your sanctuary amidst Dubai's skyline, the Creek, and boundless horizons—where vision and imagination unite as One.

Every Vista, A Work of Art

Where urban elegance meets nature's serenity, every residence offers uninterrupted views of the Dubai skyline, Ras Al Khor Wildlife Sanctuary, and the tranquil horizon—transforming every sunrise and nightscape into a magical experience.

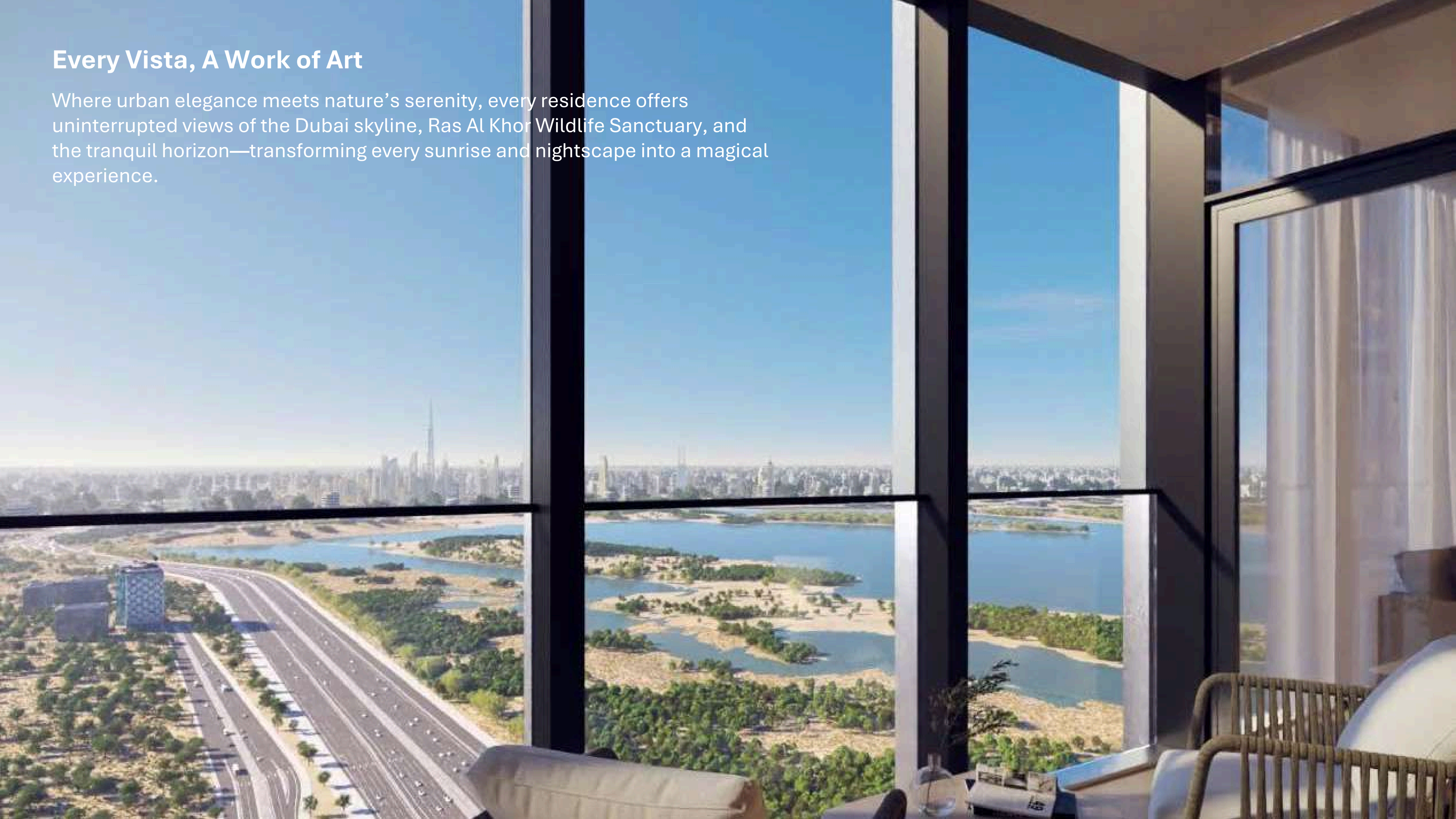

Views That Ignite Imagination

Gaze upon Dubai's skyline, where mornings bathe in gold and nights shimmer with light, creating vistas that inspire and captivate.

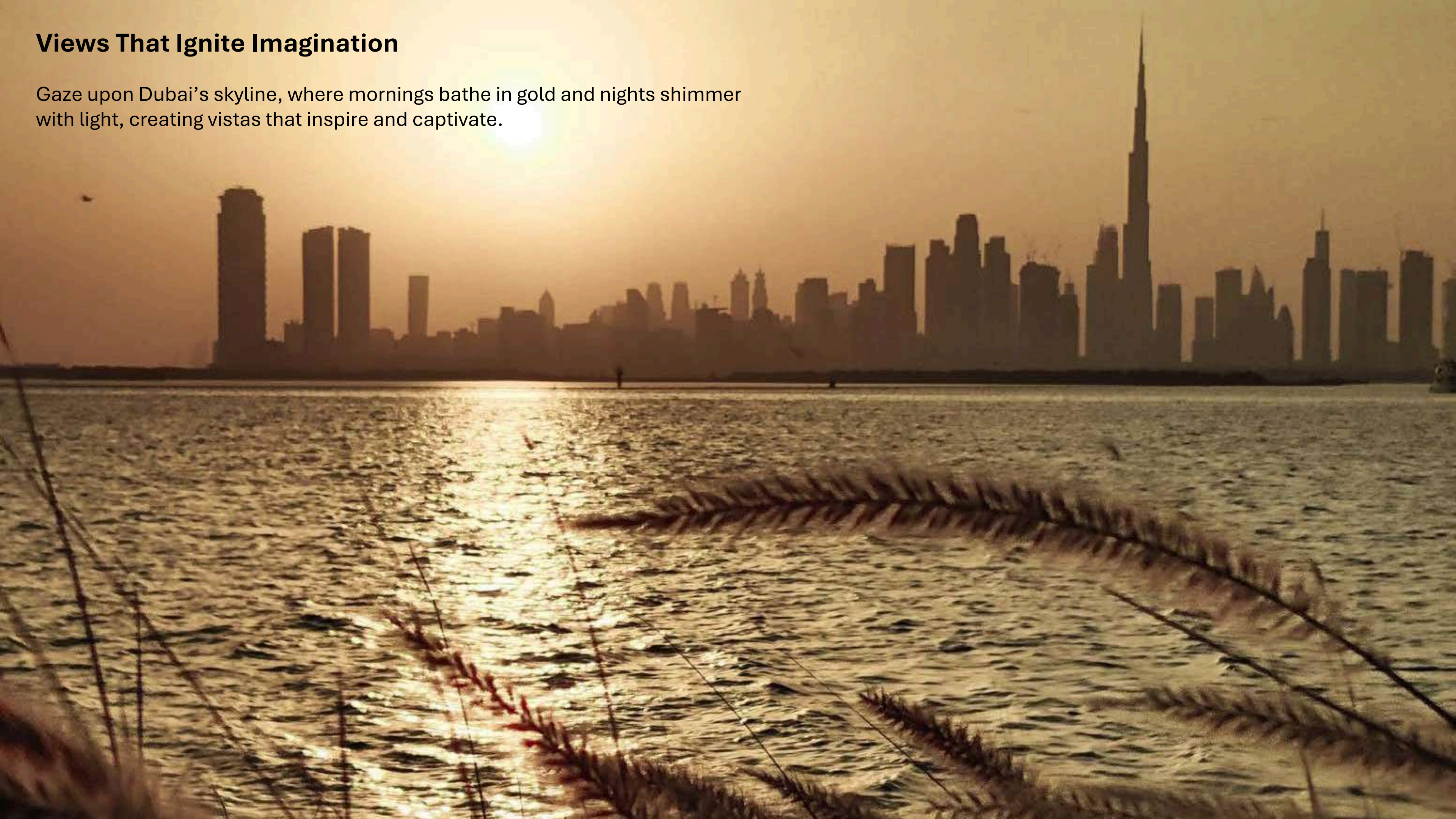



A Haven of Scenic Tranquility

Step into a world of limitless luxury and natural serenity, where sweeping views of mangroves, serene waters, and graceful flamingos meet the sophistication of urban living.



Luxury Amidst Verdant Landscapes



Immerse yourself in the harmony of lush fairways and tranquil skies, where golf course vistas redefine peaceful, sophisticated living.



A Beacon of Prestige and Sophistication

Experience spaces designed to harmonize elegance and nature, where panoramic views provide the perfect setting to relax, connect, and flourish.



Your Space. Your Retreat. Your Haven.



At The Element, community spaces blend refined design with natural beauty, offering residents a rich tapestry of experiences—from peaceful evenings to lively social gatherings—set against breathtaking vistas

Step Into a Life of World-Class Luxury

Our world-class facilities, from luxurious pools to scenic podiums and a stylish clubhouse, provide the perfect backdrop for relaxation, recreation, and cherished memories.

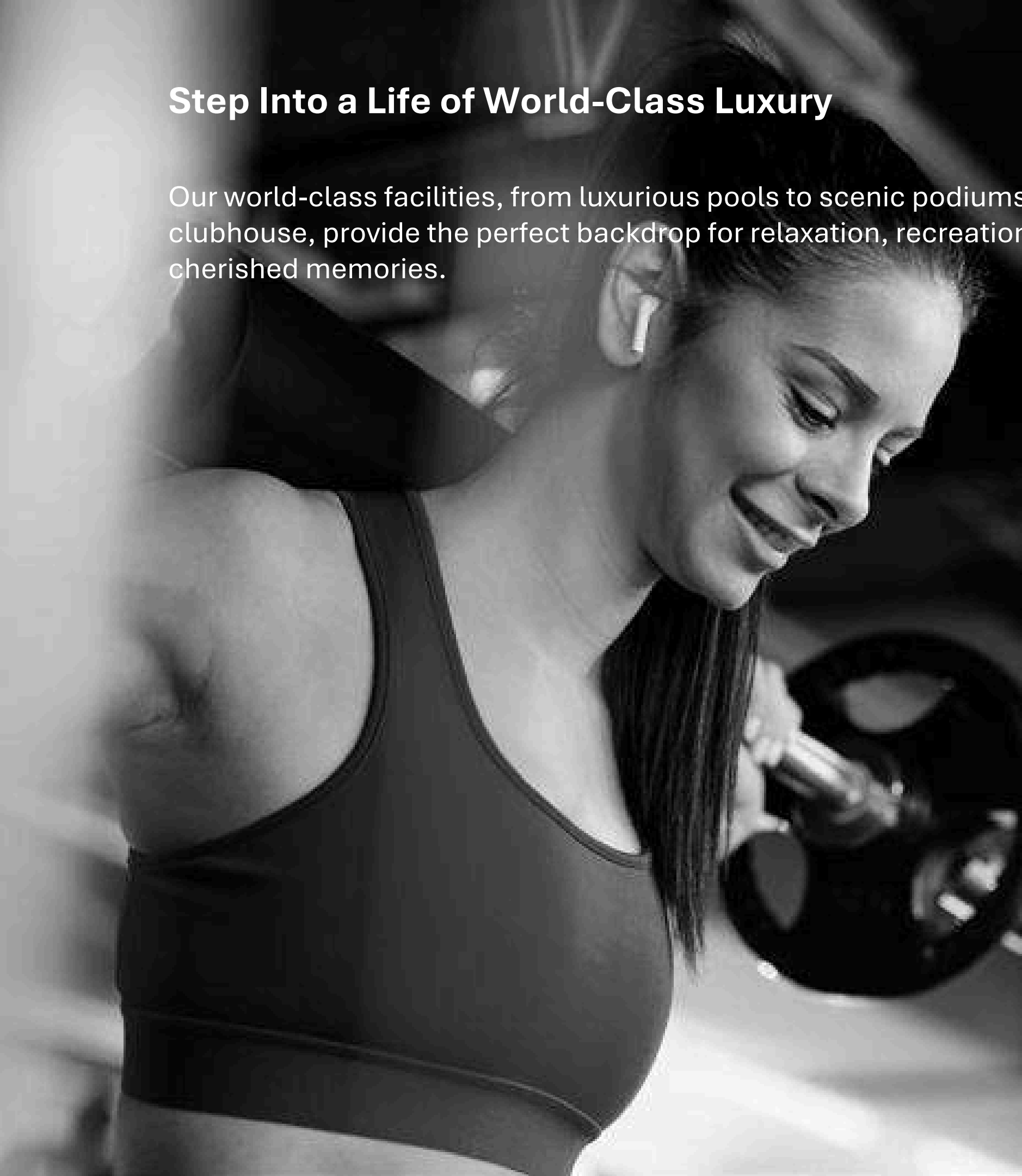



Beyond the Fairway: A Game of Distinction



Experience 18 meticulously designed holes at Dubai's first world-class Pitch & Putt golf course. Whether you're looking to unwind after a long day at work or enjoy a fun round with friends, there's nothing quite like sinking a long putt on a sun-drenched fairway. The clubhouse offers upscale amenities and a relaxing patio with stunning views of the greens—perfect for socializing or simply soaking in the scenery.

Dining by the Water

The food and beverage esplanade along the tranquil waters is a true delight for every palate. Whether it's an intimate dinner, a quick coffee catch-up, or a power lunch, it offers a range of dining experiences to suit every taste and occasion.

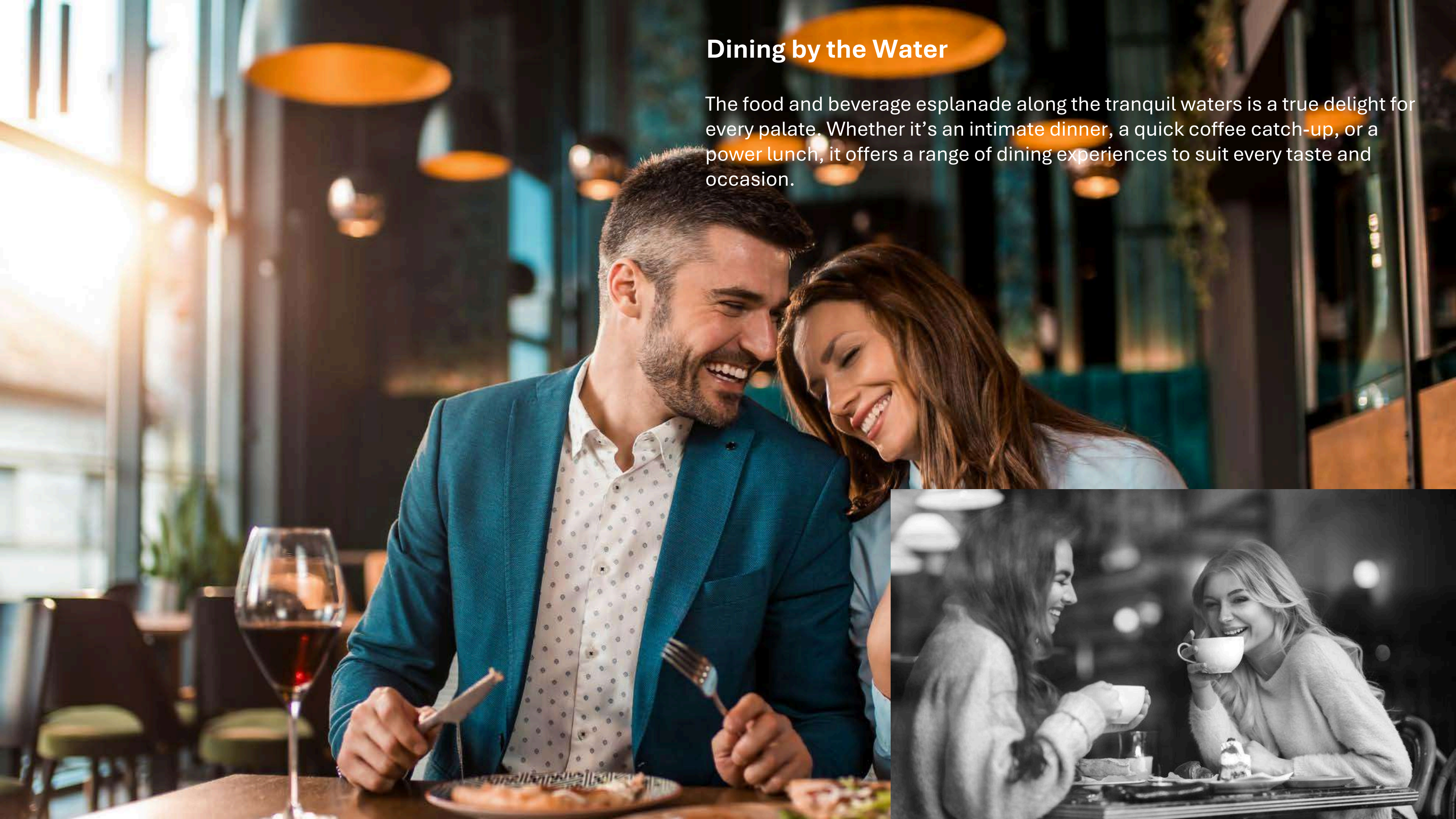

The Pinnacle of Indulgence

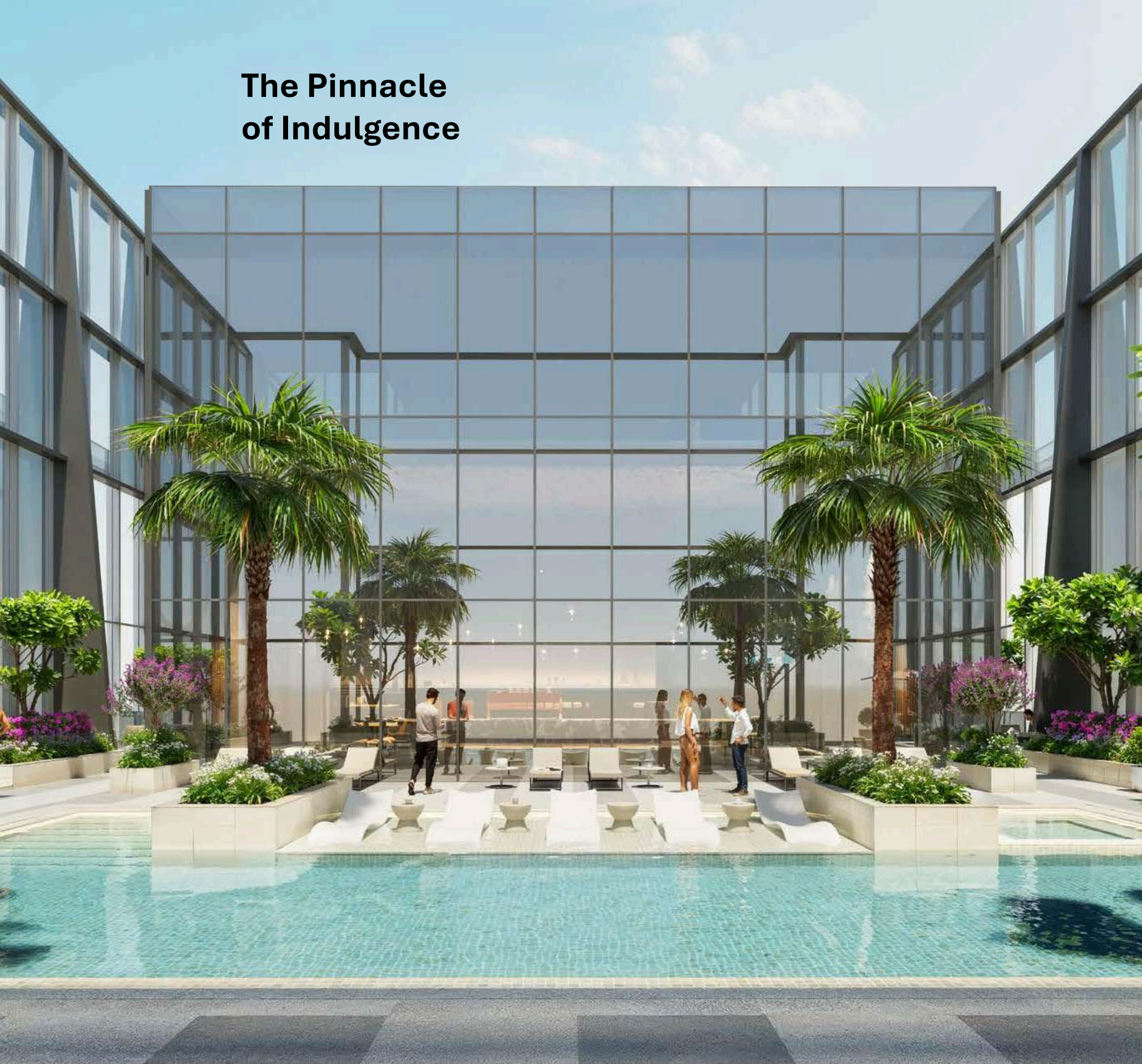

Indulge in rooftop luxury with a resort-style pool offering breathtaking 270° panoramic views and a chic observation deck. The podium level effortlessly merges indoor and outdoor spaces, featuring curated amenities for health, recreation, and entertainment—designed for a life beyond the ordinary.



Indoor
Amenities



Co-working Spaces
& Business Lounge



Cinema Room



Multipurpose Hall



VR Games/
Youth Zone



Indoor Gym



Roof Top Lounge



Pilates & Yoga



Kids Club/
Toddler Club



Library



Nursing Room

Outdoor Amenities



Swimming pool Equipped
with Aqua Fitness Activities



Jacuzzi



Padel Court



Obstacle Course or
CrossFit



Table Tennis



Battle Ropes



Observation Deck



Outdoor Gym



Children Play Area



Outdoor BBQ



Yoga/
Meditation Deck



Cycling track, Walking
Track and Cycling Track*



Lawn with Seating



Pet-Friendly spaces

Location Plan



Master Plan



Disclaimer: The images shown are for illustration purposes only and may not be an exact representation of the product" and "The images uses computer graphics technology (photorealistic rendering) to showcase the building and apartment's design, including the façade, elevations, and interiors. All furniture, lighting, finishes, facade and art shown are for marketing purposes only. All contents in these images are for illustrative purposes only and subject to change.

Site Plan



Amenities

Podium Level

- ① Circulation Walkways
- ② Kids Play Area
- ③ BBQ + Dining Area
- ④ Game Zone: Table Tennis, Foosball
- ⑤ Open Lawn
- ⑥ Yoga/ Meditation Area
- ⑦ Outdoor Gym
- ⑧ Battle Ropes
- ⑨ Obstacle Course/ Crossfit Area
- ⑩ Paddle Court
- ⑪ Raised Planter

Rooftop Level

- ⑫ Main Swimming Pool
- ⑬ Wet Deck
- ⑭ Jacuzzi
- ⑮ Kids Pool
- ⑯ Sun Loungers
- ⑰ Pool Shower
- ⑱ Observation Deck
- ⑲ Outdoor Lounge

FLOOR AND UNIT
PLANS

FLOOR AND UNIT PLANS



DISCLAIMER: 1. ALL DIMENSIONS ARE IN METRIC, MEASURED TO WALL. 2. ALL DIMENSIONS & DRAWINGS ARE APPROXIMATE. 3. ACTUAL AREA MAY VARY FROM THE STATED AREA. 4. DRAWING ARE NOT TO SCALE. 5. LAYOUT REPRESENTATION AND IMAGES ARE FOR ILLUSTRATIVE PURPOSES ONLY AND MAY NOT REPRESENT THE ACTUAL SIZE, FEATURES, SPECIFICATIONS FOR KITCHEN FIXTURES, APPLIANCES, FITTINGS, FURNITURE OR FURNISHINGS AND FACADE. ACTUAL PRODUCTS AND DETAILS MAY VARY. 6. THE DEVELOPER RESERVES THE RIGHT TO MAKE REVISIONS, ALTERATIONS, AT ITS ABSOLUTE DISCRETION, WITHOUT PRIOR INTIMATION OR ANY LIABILITY WHATSOEVER.

TYPE A
(with powder room + balcony)



1006, 1106, 1206, 1306, 1406, 1506, 1606, 1706, 1806, 1906, 2006, 2106, 2206, 2306, 2406, 2506, 2606, 2706, 2806, 2906, 3006, 3106, 3206, 3306

DISCLAIMER: 1. ALL DIMENSIONS ARE IN METRIC, MEASURED TO WALL. 2. ALL DIMENSIONS & DRAWINGS ARE APPROXIMATE. 3. ACTUAL AREA MAY VARY FROM THE STATED AREA. 4. DRAWING ARE NOT TO SCALE. 5. LAYOUT REPRESENTATION AND IMAGES ARE FOR ILLUSTRATIVE PURPOSES ONLY AND MAY NOT REPRESENT THE ACTUAL SIZE, FEATURES, SPECIFICATIONS FOR KITCHEN FIXTURES, APPLIANCES, FITTINGS, FURNITURE OR FURNISHINGS AND FACADE. ACTUAL PRODUCTS AND DETAILS MAY VARY. 6. THE DEVELOPER RESERVES THE RIGHT TO MAKE REVISIONS/ALTERATIONS, AT ITS ABSOLUTE DISCRETION, WITHOUT PRIOR INTIMATION OR ANY LIABILITY WHATSOEVER.

1

BEDROOM
APARTMENT

TYPE C

(with powder room + balcony)

TOTAL SALEABLE AREA
SUITE = 667.36 SQ.FT.
BALCONY = 86.65 SQ.FT.
TOTAL = 754.01 SQ.FT.

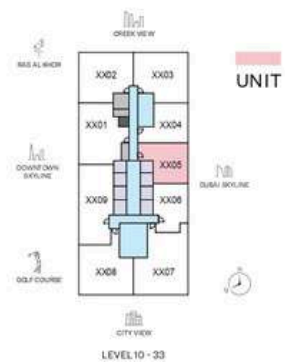

List of unit numbers with this unit plan:

VIEWS

Dubai Skyline

1005, 1105, 1205, 1305, 1405, 1505, 1605, 1705, 1805, 1905, 2005, 2105, 2205, 2305, 2405, 2505, 2605, 2705, 2805, 2905, 3005, 3105, 3205, 3305

DISCLAIMER: 1. ALL DIMENSIONS ARE IN METRIC, MEASURED TO WALL. 2. ALL DIMENSIONS & DRAWINGS ARE APPROXIMATE. 3. ACTUAL AREA MAY VARY FROM THE STATED AREA. 4. DRAWING ARE NOT TO SCALE. 5. LAYOUT REPRESENTATION AND IMAGES ARE FOR ILLUSTRATIVE PURPOSES ONLY AND MAY NOT REPRESENT THE ACTUAL SIZE, FEATURES, SPECIFICATIONS FOR KITCHEN FIXTURES, APPLIANCES, FITTINGS, FURNITURE OR FURNISHINGS AND FACADE. ACTUAL PRODUCTS AND DETAILS MAY VARY. 6. THE DEVELOPER RESERVES THE RIGHT TO MAKE REVISIONS/ ALTERATIONS, AT ITS ABSOLUTE DISCRETION, WITHOUT PRIOR INTIMATION OR ANY LIABILITY WHATSOEVER.

1

BEDROOM
APARTMENT

TYPE B

(with powder room + balcony)

TOTAL SALEABLE AREA
SUITE = 647.99 SQ.FT.
BALCONY = 89.45 SQ.FT.
TOTAL = 737.44 SQ.FT.

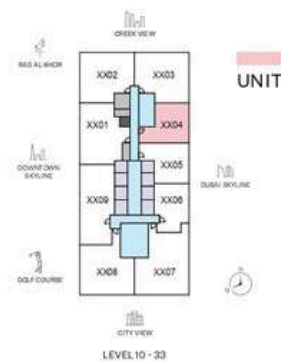

List of unit numbers with this unit plan:

VIEWS

Dubai Skyline

1004, 1104, 1204, 1304, 1404, 1504, 1604, 1704, 1804, 1904, 2004, 2104, 2204, 2304, 2404, 2504, 2604, 2704, 2804, 2904, 3004, 3104, 3204, 3304

DISCLAIMER: 1. ALL DIMENSIONS ARE IN METRIC, MEASURED TO WALL. 2. ALL DIMENSIONS & DRAWINGS ARE APPROXIMATE. 3. ACTUAL AREA MAY VARY FROM THE STATED AREA. 4. DRAWING ARE NOT TO SCALE. 5. LAYOUT REPRESENTATION AND IMAGES ARE FOR ILLUSTRATIVE PURPOSES ONLY AND MAY NOT REPRESENT THE ACTUAL SIZE, FEATURES, SPECIFICATIONS FOR KITCHEN FIXTURES, APPLIANCES, FITTINGS, FURNITURE OR FURNISHINGS AND FACADE. ACTUAL PRODUCTS AND DETAILS MAY VARY. 6. THE DEVELOPER RESERVES THE RIGHT TO MAKE REVISIONS/ ALTERATIONS, AT ITS ABSOLUTE DISCRETION, WITHOUT PRIOR INTIMATION OR ANY LIABILITY WHATSOEVER.

2

BEDROOM
APARTMENT
TYPE A

(with powder room and store room + balcony)

TOTAL SALEABLE AREA
SUITE = 1,046.25 SQ.FT.
BALCONY = 173.94 SQ.FT.
TOTAL = 1,220.19 SQ.FT.

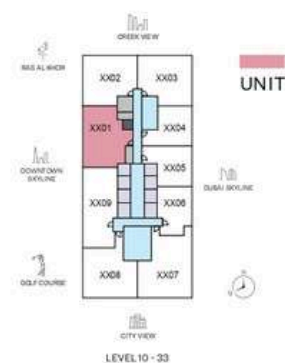

List of unit numbers with this unit plan:

VIEWS

Golf course, Ras Al Khor, Downtown Skyline, Amenities
1101, 1201, 1301, 1401, 1501

Golf course, Ras Al Khor, Downtown Skyline
1601, 1701, 1801, 1901, 2201, 2301, 2401, 2501, 2601, 2701, 2801, 2901

Ras Al Khor, Downtown Skyline
3101, 3201, 3301

DISCLAIMER: 1. ALL DIMENSIONS ARE IN METRIC, MEASURED TO WALL. 2. ALL DIMENSIONS & DRAWINGS ARE APPROXIMATE. 3. ACTUAL AREA MAY VARY FROM THE STATED AREA. 4. DRAWING ARE NOT TO SCALE. 5. LAYOUT REPRESENTATION AND IMAGES ARE FOR ILLUSTRATIVE PURPOSES ONLY AND MAY NOT REPRESENT THE ACTUAL SIZE, FEATURES, SPECIFICATIONS FOR KITCHEN FIXTURES, APPLIANCES, FITTINGS, FURNITURE OR FURNISHINGS AND FACADE. ACTUAL PRODUCTS AND DETAILS MAY VARY. 6. THE DEVELOPER RESERVES THE RIGHT TO MAKE REVISIONS/ ALTERATIONS, AT ITS ABSOLUTE DISCRETION, WITHOUT PRIOR INTIMATION OR ANY LIABILITY WHATSOEVER.

2

BEDROOM
APARTMENT
TYPE B

(with powder room + balcony)

TOTAL SALEABLE AREA
SUITE = 1,097.81 SQ.FT.
BALCONY = 86.11 SQ.FT.
TOTAL = 1,183.92 SQ.FT.

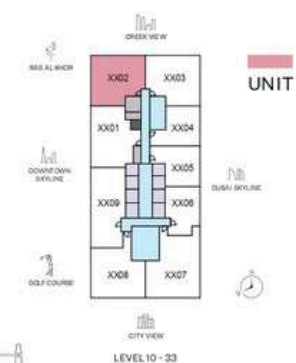

List of unit numbers with this unit plan:

VIEWS

Golf course, Ras Al Khor, Creek, Amenities
1002, 1102, 1202, 1302, 1402, 1502

Golf course, Ras Al Khor, Creek, Downtown Skyline
1602, 1702, 1802, 1902, 2002, 2102, 2202, 2302, 2402, 2502, 2602, 2702, 2802, 2902, 3002

Ras Al Khor, Creek, Downtown Skyline
3102, 3202, 3302

DISCLAIMER: 1. ALL DIMENSIONS ARE IN METRIC, MEASURED TO WALL. 2. ALL DIMENSIONS & DRAWINGS ARE APPROXIMATE. 3. ACTUAL AREA MAY VARY FROM THE STATED AREA. 4. DRAWING ARE NOT TO SCALE. 5. LAYOUT REPRESENTATION AND IMAGES ARE FOR ILLUSTRATIVE PURPOSES ONLY AND MAY NOT REPRESENT THE ACTUAL SIZE, FEATURES, SPECIFICATIONS FOR KITCHEN FIXTURES, APPLIANCES, FITTINGS, FURNITURE OR FURNISHINGS AND FACADE. ACTUAL PRODUCTS AND DETAILS MAY VARY. 6. THE DEVELOPER RESERVES THE RIGHT TO MAKE REVISIONS/ ALTERATIONS, AT ITS ABSOLUTE DISCRETION, WITHOUT PRIOR INTIMATION OR ANY LIABILITY WHATSOEVER.

2

BEDROOM
APARTMENT

TYPE C
(with powder room + balcony)

TOTAL SALEABLE AREA
SUITE = 1,189.63 SQ.FT.
BALCONY = 93.75 SQ.FT.
TOTAL = 1,283.38 SQ.FT.

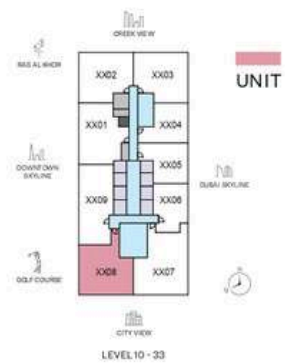

List of unit numbers with this unit plan:

VIEWS

Golf Course, Ras Al Khor, Downtown Skyline, Amenities
1008, 1108, 1208, 1308, 1408, 1508

Golf course, Ras Al Khor, Downtown Skyline
1608, 1708, 1808, 1908, 2008, 2108, 2208, 2308, 2408, 2508, 2608, 2708, 2808, 2908, 3008

Golf course, Ras Al Khor, Downtown Skyline
3108, 3208, 3308

DISCLAIMER: 1. ALL DIMENSIONS ARE IN METRIC, MEASURED TO WALL. 2. ALL DIMENSIONS & DRAWINGS ARE APPROXIMATE. 3. ACTUAL AREA MAY VARY FROM THE STATED AREA. 4. DRAWING ARE NOT TO SCALE. 5. LAYOUT REPRESENTATION AND IMAGES ARE FOR ILLUSTRATIVE PURPOSES ONLY AND MAY NOT REPRESENT THE ACTUAL SIZE, FEATURES, SPECIFICATIONS FOR KITCHEN FIXTURES, APPLIANCES, FITTINGS, FURNITURE OR FURNISHINGS AND FACADE. ACTUAL PRODUCTS AND DETAILS MAY VARY. 6. THE DEVELOPER RESERVES THE RIGHT TO MAKE REVISIONS/ ALTERATIONS, AT ITS ABSOLUTE DISCRETION, WITHOUT PRIOR INTIMATION OR ANY LIABILITY WHATSOEVER.

2

BEDROOM
APARTMENT

TYPE B - VARIANT 1
(with powder room + balcony)

TOTAL SALEABLE AREA
SUITE = 1,097.6 SQ.FT.
BALCONY = 86.11 SQ.FT.
TOTAL = 1,183.71 SQ.FT.

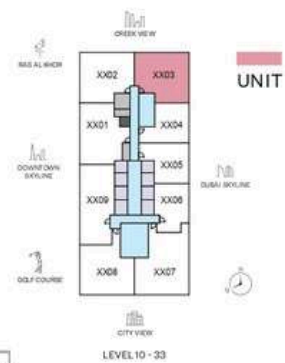

List of unit numbers with this unit plan:

VIEWS

Creek, Dubai Skyline

1003, 1103, 1203, 1303, 1403, 1503, 1603, 1703, 1803, 1903, 2003, 2103, 2203, 2303, 2403, 2503, 2603, 2703, 2803, 2903, 3003, 3103, 3203, 3303

DISCLAIMER: 1. ALL DIMENSIONS ARE IN METRIC, MEASURED TO WALL. 2. ALL DIMENSIONS & DRAWINGS ARE APPROXIMATE. 3. ACTUAL AREA MAY VARY FROM THE STATED AREA. 4. DRAWING ARE NOT TO SCALE. 5. LAYOUT REPRESENTATION AND IMAGES ARE FOR ILLUSTRATIVE PURPOSES ONLY AND MAY NOT REPRESENT THE ACTUAL SIZE, FEATURES, SPECIFICATIONS FOR KITCHEN FIXTURES, APPLIANCES, FITTINGS, FURNITURE OR FURNISHINGS AND FACADE. ACTUAL PRODUCTS AND DETAILS MAY VARY. 6. THE DEVELOPER RESERVES THE RIGHT TO MAKE REVISIONS/ ALTERATIONS, AT ITS ABSOLUTE DISCRETION, WITHOUT PRIOR INTIMATION OR ANY LIABILITY WHATSOEVER.

2

BEDROOM
APARTMENT
TYPE E

(with study room and shared powder room + balcony)

TOTAL SALEABLE AREA
SUITE = 1,336.66 SQ.FT.
BALCONY = 179.64 SQ.FT.
TOTAL = 1,516.2 SQ.FT.



List of unit numbers with this unit plan:

VIEWS

City View, Dubai Skyline

1007, 1107, 1207, 1307, 1407, 1507, 1607, 1707, 1807, 1907, 2007, 2107, 2207, 2307, 2407, 2507, 2607, 2707, 2807, 2907, 3007, 3107, 3207, 3307

DISCLAIMER: 1. ALL DIMENSIONS ARE IN METRIC, MEASURED TO WALL. 2. ALL DIMENSIONS & DRAWINGS ARE APPROXIMATE. 3. ACTUAL AREA MAY VARY FROM THE STATED AREA. 4. DRAWING ARE NOT TO SCALE. 5. LAYOUT REPRESENTATION AND IMAGES ARE FOR ILLUSTRATIVE PURPOSES ONLY AND MAY NOT REPRESENT THE ACTUAL SIZE, FEATURES, SPECIFICATIONS FOR KITCHEN FIXTURES, APPLIANCES, FITTINGS, FURNITURE OR FURNISHINGS AND FACADE. ACTUAL PRODUCTS AND DETAILS MAY VARY. 6. THE DEVELOPER RESERVES THE RIGHT TO MAKE REVISIONS/ ALTERATIONS, AT ITS ABSOLUTE DISCRETION, WITHOUT PRIOR INTIMATION OR ANY LIABILITY WHATSOEVER.

2

BEDROOM
APARTMENT
TYPE D

(with powder room + balcony)

TOTAL SALEABLE AREA
SUITE = 1,085.54 SQ.FT.
BALCONY = 176.31 SQ.FT.
TOTAL = 1,261.85 SQ.FT.



List of unit numbers with this unit plan:

VIEWS

Golf course, Ras Al Khor, Downtown Skyline, Amenities

1008, 1108, 1208, 1308, 1408, 1508

Golf course, Ras Al Khor, Downtown Skyline

1608, 1708, 1808, 1908, 2008, 2108, 2208, 2308, 2408, 2508, 2608, 2708, 2808, 2908, 3008

Golf course, Ras Al Khor, Downtown Skyline

3108, 3208, 3308

DISCLAIMER: 1. ALL DIMENSIONS ARE IN METRIC, MEASURED TO WALL. 2. ALL DIMENSIONS & DRAWINGS ARE APPROXIMATE. 3. ACTUAL AREA MAY VARY FROM THE STATED AREA. 4. DRAWING ARE NOT TO SCALE. 5. LAYOUT REPRESENTATION AND IMAGES ARE FOR ILLUSTRATIVE PURPOSES ONLY AND MAY NOT REPRESENT THE ACTUAL SIZE, FEATURES, SPECIFICATIONS FOR KITCHEN FIXTURES, APPLIANCES, FITTINGS, FURNITURE OR FURNISHINGS AND FACADE. ACTUAL PRODUCTS AND DETAILS MAY VARY. 6. THE DEVELOPER RESERVES THE RIGHT TO MAKE REVISIONS/ ALTERATIONS, AT ITS ABSOLUTE DISCRETION, WITHOUT PRIOR INTIMATION OR ANY LIABILITY WHATSOEVER.

3
BEDROOM
APARTMENT
TYPE B

(with maid's room, store room and powder room + balcony)

TOTAL SALEABLE AREA
SUITE = 1,610.28 SQ.FT.
BALCONY = 263.82 SQ.FT.
TOTAL = 1,874.10 SQ.FT.

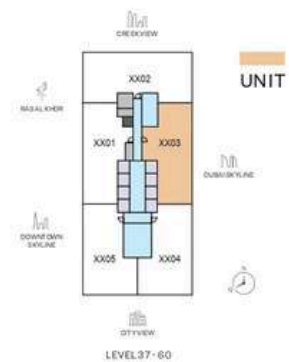

List of unit numbers with this unit plan:

VIEWS

Dubai Skyline

3703, 3803, 3903, 4003, 4103, 4203, 4303, 4403, 4503, 4603, 4703, 4803, 4903, 5003, 5103, 5203, 5303, 5403, 5503, 5603, 5703, 5803, 5903, 6003

DISCLAIMER: 1. ALL DIMENSIONS ARE IN METRIC, MEASURED TO WALL. 2. ALL DIMENSIONS & DRAWINGS ARE APPROXIMATE. 3. ACTUAL AREA MAY VARY FROM THE STATED AREA. 4. DRAWING ARE NOT TO SCALE. 5. LAYOUT REPRESENTATION AND IMAGES ARE FOR ILLUSTRATIVE PURPOSES ONLY AND MAY NOT REPRESENT THE ACTUAL SIZE, FEATURES, SPECIFICATIONS FOR KITCHEN FIXTURES, APPLIANCES, FITTINGS, FURNITURE OR FURNISHINGS AND FACADE. ACTUAL PRODUCTS AND DETAILS MAY VARY. 6. THE DEVELOPER RESERVES THE RIGHT TO MAKE REVISIONS/ ALTERATIONS, AT ITS ABSOLUTE DISCRETION, WITHOUT PRIOR INTIMATION OR ANY LIABILITY WHATSOEVER.

3
BEDROOM
APARTMENT
TYPE A

(with maid's room, store room and powder room + balcony)

TOTAL SALEABLE AREA
SUITE = 1,591.44 SQ.FT.
BALCONY = 261.56 SQ.FT.
TOTAL = 1,853.00 SQ.FT.

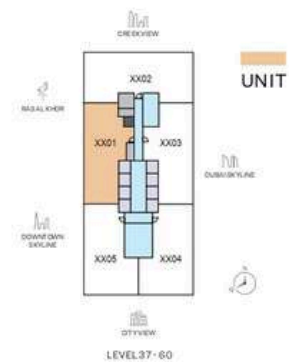

List of unit numbers with this unit plan:

VIEWS

Ras Al Khor, Downtown Skyline

3701, 3801, 3901, 401, 4201, 4301, 4401, 4501, 4601, 4801, 4901, 5101, 5201, 5301, 5401, 5501, 5601, 5701, 5801, 5901

DISCLAIMER: 1. ALL DIMENSIONS ARE IN METRIC, MEASURED TO WALL. 2. ALL DIMENSIONS & DRAWINGS ARE APPROXIMATE. 3. ACTUAL AREA MAY VARY FROM THE STATED AREA. 4. DRAWING ARE NOT TO SCALE. 5. LAYOUT REPRESENTATION AND IMAGES ARE FOR ILLUSTRATIVE PURPOSES ONLY AND MAY NOT REPRESENT THE ACTUAL SIZE, FEATURES, SPECIFICATIONS FOR KITCHEN FIXTURES, APPLIANCES, FITTINGS, FURNITURE OR FURNISHINGS AND FACADE. ACTUAL PRODUCTS AND DETAILS MAY VARY. 6. THE DEVELOPER RESERVES THE RIGHT TO MAKE REVISIONS/ ALTERATIONS, AT ITS ABSOLUTE DISCRETION, WITHOUT PRIOR INTIMATION OR ANY LIABILITY WHATSOEVER.

3 BEDROOM APARTMENT

TYPE C
(with maid's room and powder room + balcony)

TOTAL SALEABLE AREA
SUITE RANGE = 1,777.66 SQ.FT. - 1,777.88 SQ.FT.
BALCONY RANGE = 180.40 SQ.FT. - 180.51 SQ.FT.
TOTAL RANGE = 1,958.17 SQ.FT. - 1,958.28 SQ.FT.

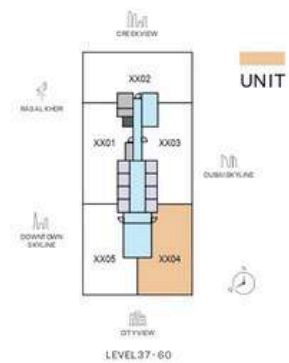

List of unit numbers with this unit plan:

VIEWS

Dubai Skyline, City view

3704, 3804, 3904, 4004, 4104, 4204, 4304, 4404, 4504, 4604, 4704, 4804, 4904, 5004, 5104, 5204, 5304, 5404, 5504, 5604, 5704, 5804, 5904, 6004

DISCLAIMER: 1. ALL DIMENSIONS ARE IN METRIC, MEASURED TO WALL. 2. ALL DIMENSIONS & DRAWINGS ARE APPROXIMATE. 3. ACTUAL AREA MAY VARY FROM THE STATED AREA. 4. DRAWING ARE NOT TO SCALE. 5. LAYOUT REPRESENTATION AND IMAGES ARE FOR ILLUSTRATIVE PURPOSES ONLY AND MAY NOT REPRESENT THE ACTUAL SIZE, FEATURES, SPECIFICATIONS FOR KITCHEN FIXTURES, APPLIANCES, FITTINGS, FURNITURE OR FURNISHINGS AND FACADE. ACTUAL PRODUCTS AND DETAILS MAY VARY. 6. THE DEVELOPER RESERVES THE RIGHT TO MAKE REVISIONS/ ALTERATIONS, AT ITS ABSOLUTE DISCRETION, WITHOUT PRIOR INTIMATION OR ANY LIABILITY WHATSOEVER.

3 BEDROOM APARTMENT

TYPE C - VARIANT 1
(with maid's room and powder room + balcony)

TOTAL SALEABLE AREA
SUITE = 1,777.34 SQ.FT.
BALCONY = 180.4 SQ.FT.
TOTAL = 1,957.74 SQ.FT.

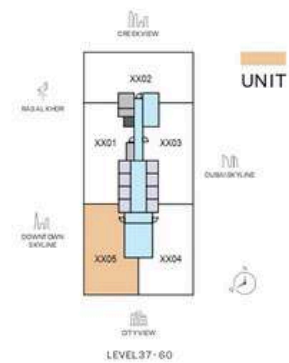

List of unit numbers with this unit plan:

VIEWS

Downtown Skyline, Community, City view

3705, 3805, 3905, 4005, 4105, 4205, 4305, 4405, 4505, 4605, 4705, 4805, 4905, 5005, 5105, 5205, 5305, 5405, 5505, 5605, 5705, 5805, 5905

DISCLAIMER: 1. ALL DIMENSIONS ARE IN METRIC, MEASURED TO WALL. 2. ALL DIMENSIONS & DRAWINGS ARE APPROXIMATE. 3. ACTUAL AREA MAY VARY FROM THE STATED AREA. 4. DRAWING ARE NOT TO SCALE. 5. LAYOUT REPRESENTATION AND IMAGES ARE FOR ILLUSTRATIVE PURPOSES ONLY AND MAY NOT REPRESENT THE ACTUAL SIZE, FEATURES, SPECIFICATIONS FOR KITCHEN FIXTURES, APPLIANCES, FITTINGS, FURNITURE OR FURNISHINGS AND FACADE. ACTUAL PRODUCTS AND DETAILS MAY VARY. 6. THE DEVELOPER RESERVES THE RIGHT TO MAKE REVISIONS/ ALTERATIONS, AT ITS ABSOLUTE DISCRETION, WITHOUT PRIOR INTIMATION OR ANY LIABILITY WHATSOEVER.

4 BEDROOM APARTMENT

TYPE A

(with maid room and shared powder + balcony)

TOTAL SALEABLE AREA

SUITE = 2,270.11 SQ.FT.

BALCONY = 172.33 SQ.FT.

TOTAL = 2,442.44 SQ.FT.

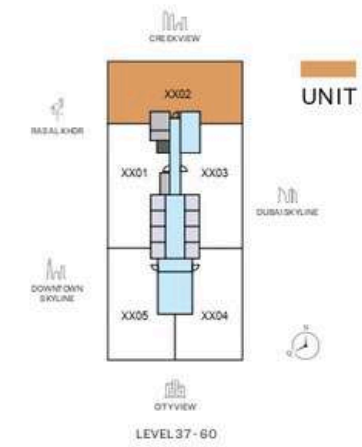

List of unit numbers with this unit plan:

VIEWS

210 degree views (Ras Al Khor, Creek, Dubai Skyline, Downtown Skyline)

3702, 3802, 3902, 4002, 4102, 4202, 4302, 4402, 4502, 4602, 4702, 4802, 4902, 5002, 5102, 5202, 5302, 5402, 5502, 5602, 5702, 5802, 5902, 6002

DISCLAIMER: 1. ALL DIMENSIONS ARE IN METRIC, MEASURED TO WALL. 2. ALL DIMENSIONS & DRAWINGS ARE APPROXIMATE. 3. ACTUAL AREA MAY VARY FROM THE STATED AREA. 4. DRAWING ARE NOT TO SCALE. 5. LAYOUT REPRESENTATION AND IMAGES ARE FOR ILLUSTRATIVE PURPOSES ONLY AND MAY NOT REPRESENT THE ACTUAL SIZE, FEATURES, SPECIFICATIONS FOR KITCHEN FIXTURES, APPLIANCES, FITTINGS, FURNITURE OR FURNISHINGS AND FACADE. ACTUAL PRODUCTS AND DETAILS MAY VARY. 6. THE DEVELOPER RESERVES THE RIGHT TO MAKE REVISIONS/ ALTERATIONS, AT ITS ABSOLUTE DISCRETION, WITHOUT PRIOR INTIMATION OR ANY LIABILITY WHATSOEVER.



Where Prestige Meets Property



At Majara Luxury Real Estate L.L.C., we redefine the art of luxury living. Based in the heart of the UAE, we specialize in curating exceptional real estate experiences tailored to the needs of discerning investors, end-users, and global clientele.



With a refined portfolio of premium properties across all seven Emirates, our expertise lies in both off-plan and ready-to-move assets, offering opportunities that blend architectural excellence with investment potential.



We are more than just property consultants & we are partners in your journey to finding the perfect home, investment, or lifestyle. Driven by integrity, market insight, and personalized service, Majara stands as a trusted name in an ever-evolving market.

Contact Us :

Phone: +971564452803

Email: info@majararealestate.com

<https://majararealestate.com/>