

An architectural rendering of a modern high-rise apartment building at dusk. The building features a central core with two wings of balconies. The balconies have glass railings and are illuminated from within, showing interior furniture and plants. The sky is a mix of blue and orange, suggesting sunset or sunrise. The building's facade is a combination of light-colored panels and dark window frames.

# THE QUAYSIDE

Where Vibrant City Living Meets Calm Tranquility



# MAJARA LUXURY REAL ESTATE LLC

Head Office Level 36-01, Po Box :124382 , Trade Center 1, Sheikh Zayed Road , Burj Al Salam Tower Dubai UAE

**The Quayside — Exclusively Offered by Majara**



A tall, modern residential building with a mix of white, grey, and terracotta-colored facades. It features numerous balconies with glass railings and some with small plants. The building is set against a clear blue sky with a few wispy clouds. In the foreground, there's a low wall and some greenery, including a palm tree on the left. To the right, a portion of another building with a grey, textured facade is visible.

## THE QUAYSIDE

Inspired by its peerless location overlooking Dubai's iconic skyline and the shimmering ,ever-charging waterways, driven by chic contemporary design and crafted to enable life lived in style. The Quayside located in the heart of Business Bay, relaxation and tranquility can be uncovered amidst the pulse of Dubai's most dynamic neighborhood.



**Day View**



**Night View**





LOBBY





**POOL DECK**





LIVING ROOM





KITCHEN





ON  
TIES

CLUBHOUSE





BOARDWALK ACCESS









POOL LOUNGERS





KID'S POOL





FITNESS STUDIO



## ZEN ROOM



## SPA ROOMS







BBQ AREA



## DRIVING DISTANCES

05  
**MINUTES**  
Business Bay Metro Station

11  
**MINUTES**  
Dubai Mall / Burj Khalifa

12  
**MINUTES**  
Museum of the Future

14  
**MINUTES**  
City Walk

15  
**MINUTES**  
Meydan Golf Course

16  
**MINUTES**  
Mall of the Emirates

17  
**MINUTES**  
Dubai Design District

18  
**MINUTES**  
Dubai International Airport

20  
**MINUTES**  
La Mer Beach

20  
**MINUTES**  
Burj Al Arab

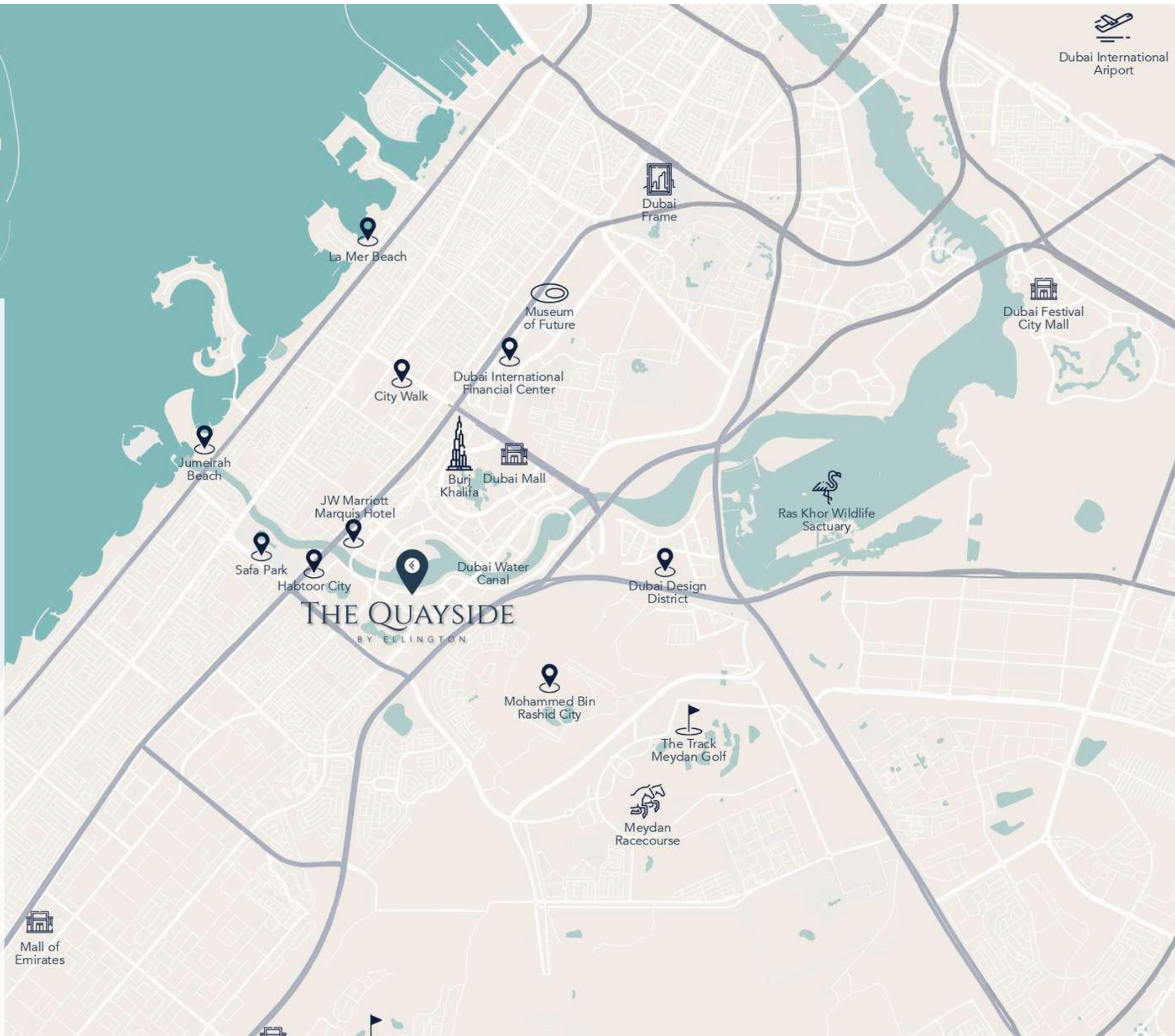



## GROUND FLOOR PLAN

- 1 Main Entrance
- 2 Lobby Entrance
- 3 Lobby Reception
- 4 Lobby Lounge
- 5 Library Wall
- 6 Move-in Truck Zone
- 7 Communal Table
- 8 Lift Lobby
- 9 Access to Lift and Lobby
- 10 Vehicle Entrance/Exit
- 11 Outdoor Seating Areas

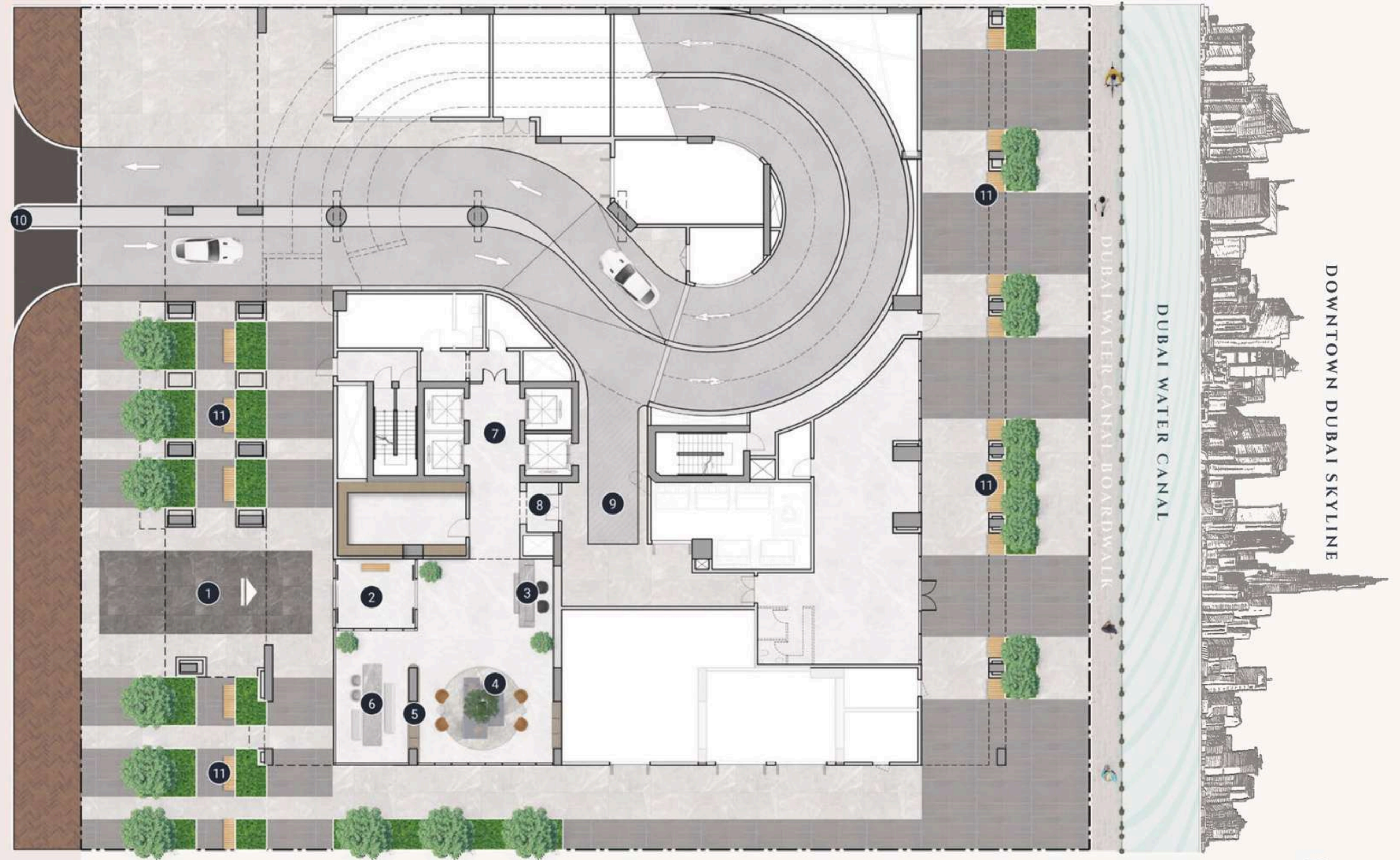



## FIRST FLOOR PLAN

- ① Leisure & Lounge Pool
- ② Cascading Waterfall
- ③ Net Seating by the Pool
- ④ Pool Sun Loungers
- ⑤ Baja Shelf
- ⑥ Cabanas
- ⑦ Kids Pool
- ⑧ Outdoor Kids Play Area
- ⑨ Indoor Kids Play Area
- ⑩ Kids Bathroom
- ⑪ Male Spa Room
- ⑫ Female Spa Room
- ⑬ Zen Room
- ⑭ Fitness Studio
- ⑮ Clubhouse
- ⑯ Kitchenette
- ⑰ Outdoor Lounge Terrace
- ⑱ Outdoor Dining Area
- ⑲ Pizza Oven and Barbeque Area
- ⑳ Lift Lobby





STUDIO



1<sup>ST</sup> FLOOR

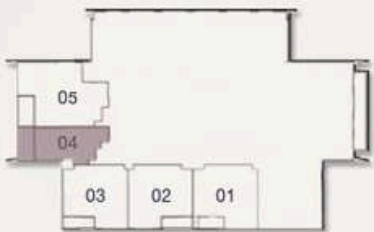

2<sup>ND</sup> - 15<sup>TH</sup> FLOOR

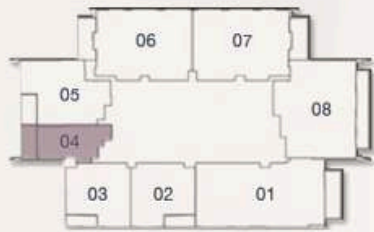

Internal Living Area

Outdoor Living Area

Total Living Area

438.52 sq.ft.

103.55 sq.ft.

542.07 sq.ft.

1 BEDROOM - TYPE A



1<sup>ST</sup> FLOOR



2<sup>ND</sup> - 15<sup>TH</sup> FLOOR

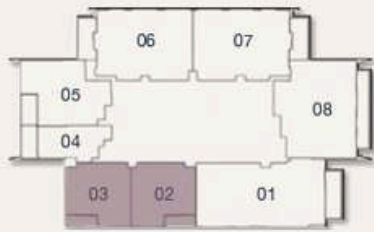

Internal Living Area

Outdoor Living Area

Total Living Area

700.30 sq.ft.

68.46 sq.ft.

768.76 sq.ft.



1 BEDROOM - TYPE B



1<sup>ST</sup> FLOOR

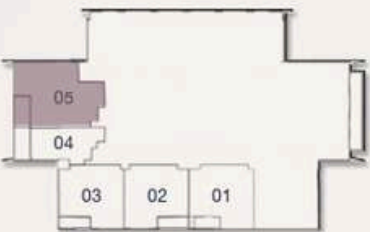

2<sup>ND</sup> - 15<sup>TH</sup> FLOOR

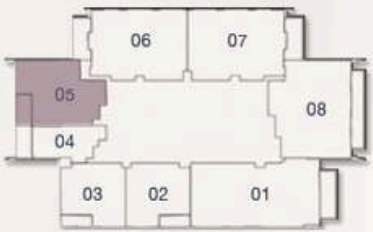

Internal Living Area	Outdoor Living Area	Total Living Area
893.19 sq.ft.	92.89 sq.ft.	986.08 sq.ft.

2 BEDROOM - TYPE A



1<sup>ST</sup> FLOOR

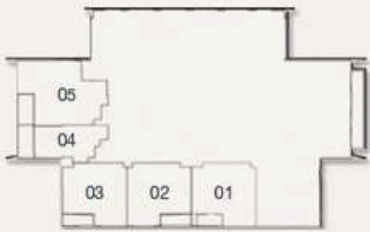

2<sup>ND</sup> - 15<sup>TH</sup> FLOOR

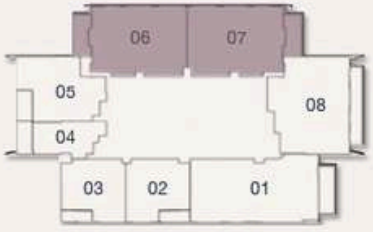

Internal Living Area	Outdoor Living Area	Total Living Area
1280.47 sq.ft.	139.93 sq.ft.	1420.41 sq.ft.



## 2 BEDROOM - TYPE B



1<sup>ST</sup> FLOOR

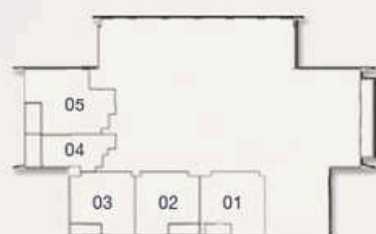

2<sup>ND</sup> - 15<sup>TH</sup> FLOOR

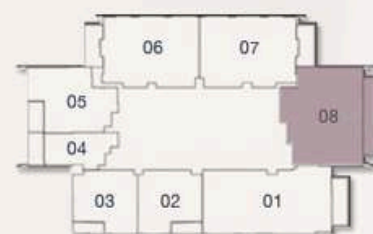

Internal Living Area	Outdoor Living Area	Total Living Area
1382.19 sq.ft.	185.68 sq.ft.	1567.87 sq.ft.

## 3 BEDROOM - TYPE A



1<sup>ST</sup> FLOOR

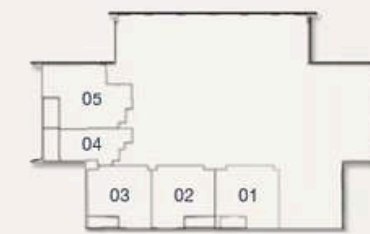

2<sup>ND</sup> - 15<sup>TH</sup> FLOOR

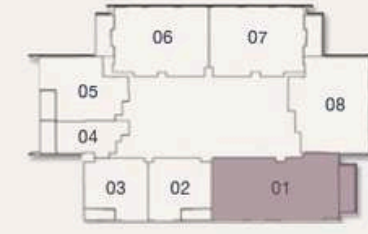

Internal Living Area	Outdoor Living Area	Total Living Area
1595.21 sq.ft.	144.02 sq.ft.	1739.23 sq.ft.





## Where Prestige Meets Property



At Majara Luxury Real Estate L.L.C., we redefine the art of luxury living. Based in the heart of the UAE, we specialize in curating exceptional real estate experiences tailored to the needs of discerning investors, end-users, and global clientele.



With a refined portfolio of premium properties across all seven Emirates, our expertise lies in both off-plan and ready-to-move assets, offering opportunities that blend architectural excellence with investment potential.



We are more than just property consultants & we are partners in your journey to finding the perfect home, investment, or lifestyle. Driven by integrity, market insight, and personalized service, Majara stands as a trusted name in an ever-evolving market.

### Contact Us :

**Phone: +971564452803**

**Email: [info@majararealestate.com](mailto:info@majararealestate.com)**

**<https://majararealestate.com/>**